



Calpe

Apartament przy plaży

Numer oferty: 4953

Od 470000 €

*Cena nie zawiera podatku VAT



Termin oddania:



Informacje o nieruchomości

Typ: Apartament

Ilość łazienek: 1

Ilość sypialni: 1

Powierzchnia: 37.68 m²

Miasto: Calpe













Opis nieruchomości

Ekskluzywna nieruchomość z bezpośrednim dostępem do plaży. Szlachetne materiały i ogromna ilość roślinności zapewniają doskonałą harmonię między domami a środowiskiem naturalnym, w którym się znajdują. Mieszkania i penthousy z dużymi, jasnymi przestrzeniami i spektakularnymi tarasami o powierzchni ponad 20 m² w większości nieruchomości, które dzięki przeszklonym balustradom oferują wspaniałe widoki.

Apartamenty, penthouse'y z 1, 2, 3 i 4 sypialniami i wspaniałymi tarasami. Z widokiem na morze na wzgórzu przed „Isla del Fraile” ze spektakularnymi widokami. Apartamenty zostały zaprojektowane tak, aby jak najlepiej wykorzystać naturalne światło i spektakularne widoki na Morze Śródziemne z ich dużych tarasów.



Atuty

- | | | |
|---|--|--|
|  Pierwsza linia brzegowa |  Klimatyzacja |  Basen ogólnodostępny |
|  Balkon/taras |  Blisko morza |  Parking |
|  Winda |  Ogród |  Garaż |
|  Osiedle zamknięte | | |



Co otrzymamy w cenie

- | | |
|--|--|
|  Umebrowana kuchnia |  Basen ogólnodostępny |
|  Klimatyzacja |  Łazienka umebrowana |



Galeria

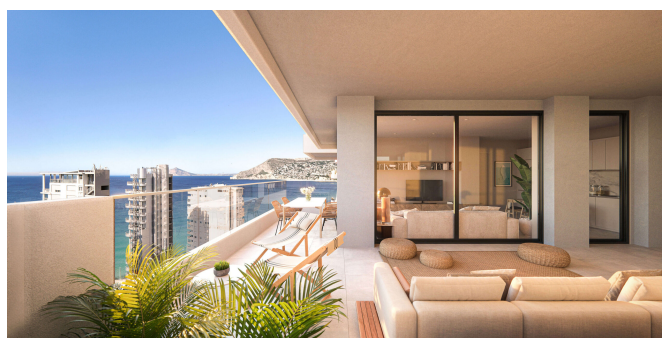



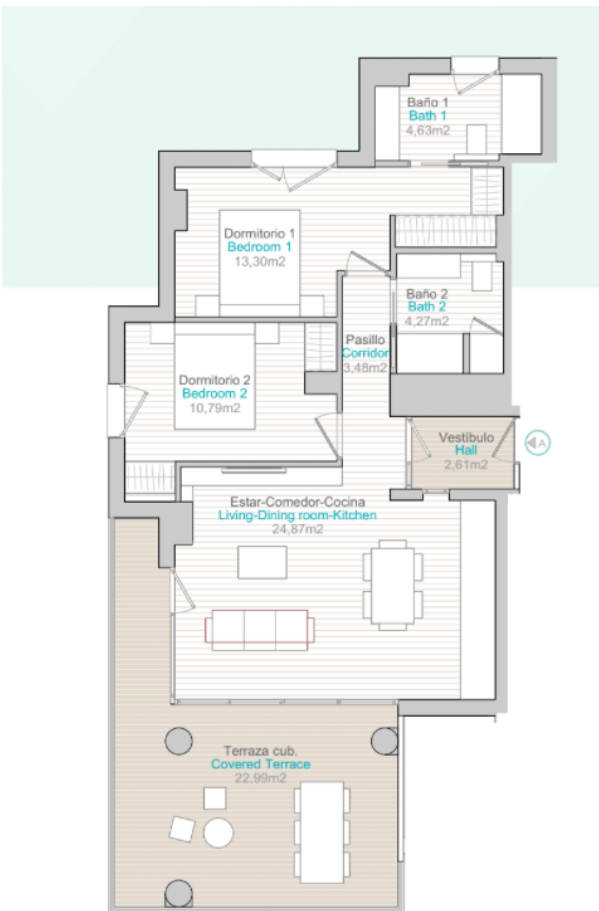
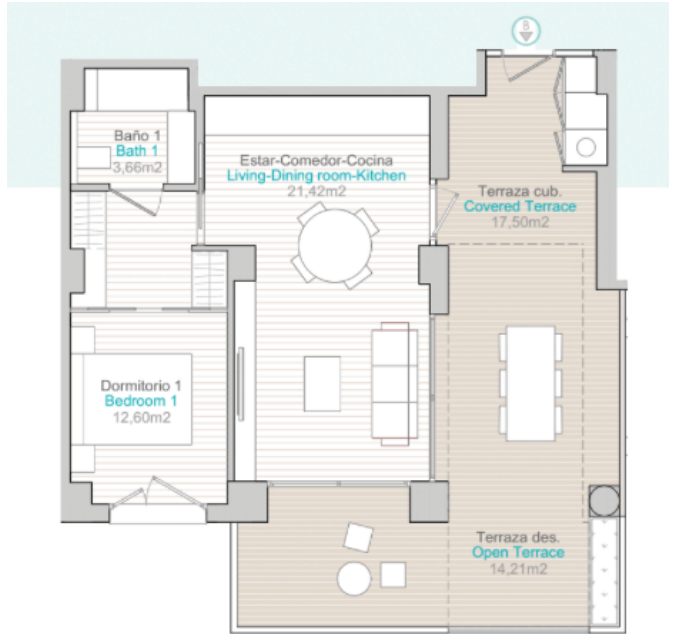
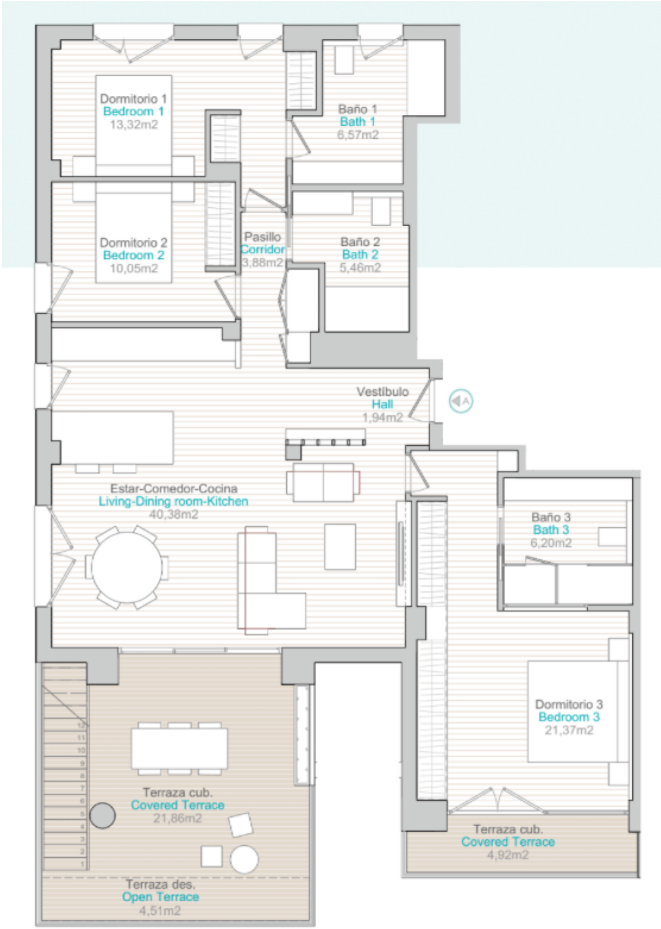

Tower	Floor	Door	Apartment	Bedrooms	Net sq. Apartments	Instr build sqm	Covered terrace	Open terrace	Solarium	Total terrace	Total build sqm	Orientation	TOTAL PRICE [VAT net inc.]	VAT	TOTAL PRICE [VAT inc.]	
1	1	A	1.0	2	62,48	77,07	28,87	6,87	0,00	35,74	132,44	OESTE	RESERVED			
1	1	B	1.0	1	22,66	46,11	16,85	15,20	0,00	32,05	88,28	OCCIDENTAL	RESERVED			
1	1	C	1.0	2	44,77	61,06	20,94	10,89	0,00	31,83	112,89	ESTE	RESERVED			
1	2	A	2.0	4	63,82	78,50	12,30	17,92	0,00	30,20	110,80	OESTE	RESERVED			
1	2	B	2.0	1	36,83	45,30	14,63	5,79	0,00	20,42	65,72	OCCIDENTAL	RESERVED			
1	2	C	2.0	2	46,95	61,26	20,03	8,98	0,00	28,01	110,28	ESTE	RESERVED			
1	3	A	3.0	2	41,33	75,37	20,83	6,50	0,00	27,33	102,70	OESTE	RESERVED			
1	3	B	3.0	1	36,83	44,61	16,50	5,27	0,00	21,76	78,38	OCCIDENTAL	RESERVED			
1	3	C	3.0	2	42,7	76,49	20,79	2,53	0,00	23,32	108,21	ESTE	RESERVED			
1	4	A	4.0	2	42,44	77,07	22,19	2,53	0,00	24,69	111,76	OESTE	RESERVED			
1	4	B	4.0	1	36,83	45,32	15,11	5,79	0,00	20,90	86,27	OCCIDENTAL	RESERVED			
1	4	C	4.0	2	42,79	76,49	20,66	6,80	0,00	27,46	112,65	ESTE	RESERVED			
1	5	A	5.0	2	42,44	77,07	24,52	10,23	0,00	34,75	111,84	OESTE	RESERVED			
1	5	B	5.0	1	36,83	44,39	19,99	12,83	0,00	32,82	76,41	OCCIDENTAL	RESERVED			
1	5	C	5.0	2	46,32	61,26	22,80	8,98	0,00	31,78	112,24	ESTE	RESERVED			
1	6	A	6.0	2	42,7	76,49	22,79	10,20	0,00	32,99	113,69	OESTE	RESERVED			
1	6	B	6.0	1	36,83	45,30	15,79	5,79	0,00	21,58	86,48	OCCIDENTAL	RESERVED			
1	6	C	6.0	2	42,83	76,50	16,79	27,67	0,00	44,47	124,17	ESTE	RESERVED			
1	7	A	7.0	2	42,44	77,07	26,84	9,40	0,00	36,24	114,69	OESTE	RESERVED			
1	7	B	7.0	1	36,83	44,39	16,79	12,67	0,00	29,46	76,06	OCCIDENTAL	RESERVED			
1	7	C	7.0	2	42,54	75,37	23,22	0,20	0,00	23,22	102,69	ESTE	RESERVED			
1	8	A	8.0	1	36,83	45,30	15,26	5,78	0,00	21,04	85,71	OCCIDENTAL	RESERVED			
1	8	B	8.0	2	42,44	77,07	26,79	2,01	0,00	28,79	107,81	OESTE	RESERVED			
1	8	C	8.0	1	36,83	45,30	15,26	5,78	0,00	21,04	85,71	OCCIDENTAL	RESERVED			
1	8	D	8.0	2	73,84	89,68	24,67	8,23	0,00	32,90	122,60	ESTE	RESERVED			
1	9	A	9.0	2	42,82	76,50	15,28	27,79	0,00	43,07	119,29	OESTE	RESERVED			
1	9	B	9.0	1	36,83	44,39	16,79	12,67	0,00	29,46	76,06	OCCIDENTAL	RESERVED			
1	9	C	9.0	2	42,44	77,07	26,79	2,01	0,00	28,79	107,81	OESTE	RESERVED			
1	9	D	9.0	1	36,83	45,30	15,26	5,78	0,00	21,04	85,71	OCCIDENTAL	RESERVED			
1	10	A	10.0	2	73,84	89,68	24,67	8,23	0,00	32,90	122,60	ESTE	RESERVED			
1	10	B	10.0	1	41,24	75,37	23,22	0,20	0,00	23,22	102,57	OESTE	RESERVED			
1	10	C	10.0	2	36,83	44,39	24,23	7,27	0,00	31,50	76,66	OCCIDENTAL	RESERVED			
1	10	D	10.0	1	36,83	44,39	24,62	16,40	0,00	41,02	117,41	ESTE	RESERVED			
1	12	A	12.0	2	42,23	76,49	20,46	4,47	0,00	24,93	111,42	OESTE	RESERVED			
1	12	B	12.0	1	36,83	44,39	19,79	12,83	0,00	32,62	76,41	OCCIDENTAL	RESERVED			
1	12	C	12.0	2	73,83	89,22	23,80	12,54	0,00	36,34	124,56	ESTE	RESERVED			
1	12	D	12.0	1	42,44	77,07	26,80	12,62	0,00	39,42	119,69	OESTE	RESERVED			
1	12	E	12.0	1	36,83	45,30	14,43	5,79	0,00	20,22	85,72	OCCIDENTAL	RESERVED			
1	12	F	12.0	2	42,44	77,07	26,80	12,62	0,00	39,42	119,69	OESTE	RESERVED			
1	14	A	14.0	2	73,83	89,22	23,80	12,54	0,00	36,34	124,56	ESTE	RESERVED			
1	14	B	14.0	1	36,83	44,39	19,79	12,83	0,00	32,62	76,41	OCCIDENTAL	RESERVED			
1	14	C	14.0	2	42,44	77,07	26,80	12,62	0,00	39,42	119,69	OESTE	RESERVED			
1	14	D	14.0	1	36,83	45,30	14,43	5,79	0,00	20,22	85,72	OCCIDENTAL	RESERVED			
1	15	A	15.0	2	42,44	77,07	26,80	12,62	0,00	39,42	119,69	OESTE	RESERVED			
1	15	B	15.0	1	36,83	44,39	19,79	12,83	0,00	32,62	76,41	OCCIDENTAL	RESERVED			
1	15	C	15.0	2	73,83	89,22	23,80	12,54	0,00	36,34	124,56	ESTE	RESERVED			
1	15	D	15.0	1	36,83	45,30	14,43	5,79	0,00	20,22	85,72	OCCIDENTAL	RESERVED			
1	15	E	15.0	2	42,44	77,07	26,80	12,62	0,00	39,42	119,69	OESTE	RESERVED			
1	15	F	15.0	1	36,83	45,30	14,43	5,79	0,00	20,22	85,72	OCCIDENTAL	RESERVED			
1	17	A	17.0	3	76,11	91,35	19,26	8,19	0,00	27,45	118,60	OESTE	RESERVED	800.000	85.000	895.000
1	17	C	17.0	2	72,65	90,20	24,60	0,20	0,00	24,80	120,00	OESTE	RESERVED			

1	1	A	1.8	2	62.64	72.07	26.87	6.50	0.00	20.87	124.64	CEXIP	RESERVADO			
2	1	B	1.8	1	27.68	46.71	18.85	0.30	0.00	34.15	80.28	CENTRAL	RESERVADO			
3	1	C	1.2	2	66.7	82.26	28.94	18.00	0.00	21.83	124.64	ETFE	RESERVADO			
4	2	A	2.4	2	43.82	29.50	12.38	0.79	0.00	41.16	124.64	CEXIP	RESERVADO			
5	2	B	1.8	1	70.81	45.25	14.63	5.78	0.00	20.42	61.71	CENTRAL	RESERVADO			
6	2	C	2.2	2	44.19	81.25	25.02	4.88	0.00	29.89	171.74	ETFE	RESERVADO			
7	3	A	3.6	2	81.54	75.37	24.83	6.98	0.00	23.37	102.70	CEXIP	RESERVADO			
8	3	B	2.8	1	36.87	44.41	16.38	12.57	0.00	31.95	76.36	CENTRAL	RESERVADO			
9	3	C	2.2	2	62.7	76.49	23.99	7.21	0.00	32.40	171.89	ETFE	RESERVADO			
10	4	A	4.8	2	42.44	77.07	22.16	1.73	0.00	37.27	114.38	CEXIP	RESERVADO			
11	4	B	3.6	1	36.81	45.32	15.77	8.76	0.00	28.40	76.20	CENTRAL	RESERVADO			
12	4	C	2.2	2	42.19	76.49	25.66	6.50	0.00	36.16	124.64	ETFE	RESERVADO			
13	5	A	5.4	2	42.44	77.07	24.12	10.15	0.00	34.27	171.84	CEXIP	RESERVADO			
14	5	B	4.8	1	36.87	44.50	16.98	12.02	0.00	22.02	76.41	CENTRAL	RESERVADO			
15	5	C	2.2	2	46.12	81.05	22.80	8.58	0.00	31.38	152.47	ETFE	RESERVADO			
16	6	A	6.6	2	42.7	76.49	27.39	5.12	0.00	22.72	108.27	CEXIP	RESERVADO			
17	6	B	4.8	1	36.82	45.30	15.79	8.79	0.00	21.08	46.38	CENTRAL	RESERVADO			
18	6	C	2.2	2	43.81	79.50	16.79	12.62	0.00	44.41	171.74	ETFE	RESERVADO			
19	7	A	7.2	2	42.44	77.07	28.44	12.77	0.00	48.15	122.22	CEXIP	RESERVADO			
20	7	B	6.0	1	36.82	44.50	16.38	12.62	0.00	21.95	76.34	CENTRAL	RESERVADO			
21	7	C	2.2	2	43.34	75.37	27.32	8.00	0.00	27.32	102.49	ETFE	RESERVADO			
22	8	A	8.4	2	42.44	77.07	26.75	8.00	0.00	28.75	105.62	CEXIP	RESERVADO			
23	8	B	6.6	1	36.82	45.30	15.26	8.15	0.00	20.47	45.71	CENTRAL	RESERVADO			
24	8	C	2.2	2	72.64	89.48	26.47	6.28	0.00	15.82	122.40	ETFE	RESERVADO			
25	9	A	9.6	2	43.82	76.50	12.38	10.72	0.00	41.10	122.40	CEXIP	RESERVADO			
26	9	B	8.4	1	37.58	46.31	20.99	5.77	0.00	21.90	80.07	CENTRAL	RESERVADO			
27	9	C	2.2	2	72.64	80.25	22.77	6.44	0.00	31.47	124.64	ETFE	RESERVADO			
28	10	A	10.8	2	42.44	77.07	29.06	16.48	0.00	48.52	126.99	CEXIP	RESERVADO			
29	10	B	10.8	1	36.82	44.29	16.79	12.58	0.00	21.95	76.54	CENTRAL	RESERVADO			
30	10	C	2.2	2	42.44	77.07	29.06	16.48	0.00	48.52	126.99	ETFE	RESERVADO			
31	11	A	11.4	2	72.63	89.48	26.12	10.01	0.00	36.54	126.22	CEXIP	RESERVADO			
32	11	B	11.4	1	36.82	45.31	14.63	5.79	0.00	20.42	45.72	CENTRAL	RESERVADO			
33	11	C	2.2	2	42.44	77.07	22.02	5.72	0.00	28.70	105.62	ETFE	RESERVADO			
34	12	A	12.6	2	42.22	76.49	30.46	4.47	0.00	34.99	171.42	CEXIP	RESERVADO			
35	12	B	12.6	1	36.81	44.50	15.79	12.02	0.00	21.82	76.41	CENTRAL	RESERVADO			
36	12	C	2.2	2	72.61	80.25	21.80	12.74	0.00	33.94	124.64	ETFE	RESERVADO			
37	13	A	13.2	2	42.44	77.07	29.40	12.62	0.00	42.37	118.44	CEXIP	RESERVADO			
38	13	B	13.2	1	36.81	45.30	14.63	5.79	0.00	20.40	45.71	CENTRAL	RESERVADO			
39	13	C	2.2	2	72.61	89.48	21.44	1.01	0.00	22.45	122.11	ETFE	RESERVADO	68.000	748.000	
40	14	A	14.4	2	72.63	80.22	21.80	8.41	0.00	31.47	124.64	CEXIP	RESERVADO			
41	14	B	14.4	1	36.81	44.50	16.26	12.62	0.00	21.83	76.41	CENTRAL	RESERVADO			
42	14	C	2.2	2	43.81	29.50	15.89	27.62	0.00	43.81	123.27	ETFE	RESERVADO			
43	15	A	15.6	2	72.63	89.48	24.68	10.06	0.00	35.54	126.22	CEXIP	RESERVADO			
44	15	B	15.6	1	36.88	44.67	14.63	5.79	0.00	20.42	45.07	CENTRAL	RESERVADO			
45	15	C	2.2	2	46.36	77.06	18.00	6.00	0.00	28.90	102.49	ETFE	RESERVADO			
46	16	A	16.8	2	72.63	80.21	22.06	9.38	0.00	31.40	124.64	CEXIP	RESERVADO	725.000	72.500	874.500
47	16	B	16.8	1	36.87	44.62	24.99	2.48	0.00	24.97	76.49	CENTRAL	RESERVADO			
48	16	C	2.2	2	42.44	77.07	26.99	6.88	0.00	36.79	118.48	ETFE	RESERVADO			
49	17	A	17.4	2	76.11	81.26	19.06	8.17	0.00	21.22	118.28	CEXIP	RESERVADO	21.000	810.000	
50	17	B	17.4	1	17.66	45.70	17.16	4.60	0.00	10.46	70.36	CENTRAL	RESERVADO	40.000	47.000	517.000
51	17	C	2.2	2	17.61	80.22	11.40	4.12	0.00	18.25	120.74	ETFE	RESERVADO	80.000	81.000	815.000
52	18	A	18.6	2	120.11	120.11	120.11	0.00	120.11	120.11	120.11	CEXIP	RESERVADO	1.000.000	1.000.000	1.000.000
53	18	B	18.6	1	120.11	120.11	120.11	0.00	120.11	120.11	120.11	CEXIP	RESERVADO			

Kasia Wabia

Aria Home Invest S.L.U

+48 601 56 88 44

+34 674 427 308

hello@ariaspain.com

www.ariaspain.com

