



Apartment in Finestrat

Offer ID: 1031

From 370000 €

*Price does not include VAT



Completion date:
grudzień 2024 - wrzesień 2025



Property Information

Type:

Number of bathrooms: 2

Number of bedrooms: 2

Area: 112.25 m²

City:



Property Description

Introducing a new construction project in Finestrat, which offers spacious flats and duplexes with two or three bedrooms and large terraces. The entire development is surrounded by gardens and the carefully planned development guarantees sea views for every unit.

The surrounding area is conducive to outdoor activities such as cycling, walking and jogging, thanks to the extensive paths. The complex will also feature amenities such as an infinity-edge pool, paddle courts, indoor pool, gym, spa with Jacuzzi and Finnish sauna, as well as co-working spaces.

This residential complex provides an intimate atmosphere in a beautiful location, close to the beach and the city. Its location adjacent to Benidorm allows you to enjoy a wider range of entertainment and dining options.



Advantages



Sea view



Air conditioning



Shared pool



Balcony/Terrace



Parking



Garden



Gated community



What is included in the price



Furnished kitchen



Parking space



Shared pool



Air conditioning



Garden



Pre-installed air conditioning



Furnished bathroom



Gallery





Poniente 3
Planta 4 Puerta C
APARTAMENTO
VV TIPO 6

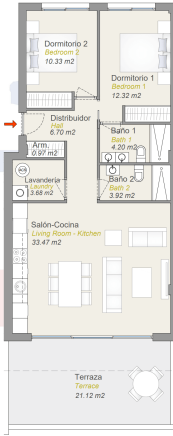

TU CASA, TU VIDA

| SUPERFICIES ÚTILES | |
|-----------------------|----------------------|
| PLANTA PRINCIPAL | |
| DISTRIBUIDOR | 6.50 m ² |
| ARMARIO | 0.97 m ² |
| SALÓN-COMEDOR-COCINA | 33.47 m ² |
| DORMITORIO 1 | 12.32 m ² |
| DORMITORIO 2 | 10.33 m ² |
| BAÑO 1 | 4.20 m ² |
| BAÑO 2 | 3.80 m ² |
| LAVANDERÍA | 3.80 m ² |
| TERRAZA | 21.12 m ² |
| TOTAL SUPERFICIE ÚTIL | 96.71 m ² |

| SUPERFICIES CONST APROX. + PP. ZZCC. | |
|--------------------------------------|-----------------------|
| SUP. PLANTA PRINCIPAL + PP. DE ZZCC. | 112.22 m ² |
| SUP. TERRAZA-JARDÍN | 23.44 m ² |
| TOTAL VIV. + TERRAZAS + ZZCC. | 135.66 m ² |



Las imágenes cartográficas contenidas en esta publicación son orientativas, no contractuales y están sujetas a modificación de proyecto. This is non-contractual document. The imperative determination of executive project can change.

Poniente 2
Planta Baja Puerta A
APARTAMENTO
VV TIPO 1X

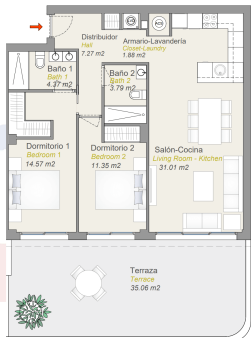

TU CASA, TU VIDA

| SUPERFICIES ÚTILES | |
|-----------------------|-----------------------|
| PLANTA PRINCIPAL | |
| DISTRIBUIDOR | 7.27 m ² |
| SALÓN-COMEDOR-COCINA | 31.25 m ² |
| DORMITORIO 1 | 14.57 m ² |
| DORMITORIO 2 | 11.35 m ² |
| BAÑO 1 | 4.97 m ² |
| BAÑO 2 | 3.79 m ² |
| ARMARIO | 1.88 m ² |
| TERRAZA | 35.08 m ² |
| TOTAL SUPERFICIE ÚTIL | 109.30 m ² |

| SUPERFICIES CONST APROX. + PP. ZZCC. | |
|--------------------------------------|-----------------------|
| SUP. PLANTA PRINCIPAL + PP. DE ZZCC. | 112.25 m ² |
| SUP. TERRAZA | 36.29 m ² |
| TOTAL VIV. + TERRAZAS + ZZCC. | 150.51 m ² |



Las imágenes cartográficas contenidas en esta publicación son orientativas, no contractuales y están sujetas a modificación de proyecto. This is non-contractual document. The imperative determination of executive project can change.

Poniente 5
Planta 4 Puerta D
APARTAMENTO
VV TIPO 5

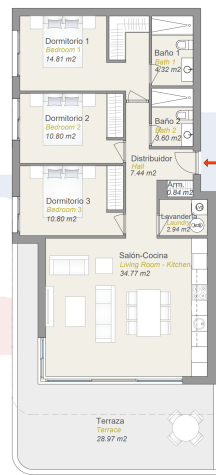

TU CASA, TU VIDA

| SUPERFICIES ÚTILES | |
|-----------------------|-----------------------|
| PLANTA PRINCIPAL | |
| DISTRIBUIDOR | 7.44 m ² |
| ARMARIO | 0.86 m ² |
| SALÓN-COMEDOR-COCINA | 34.77 m ² |
| DORMITORIO 1 | 14.81 m ² |
| DORMITORIO 2 | 10.80 m ² |
| DORMITORIO 3 | 10.80 m ² |
| BAÑO 1 | 4.30 m ² |
| BAÑO 2 | 3.80 m ² |
| LAVANDERÍA | 2.94 m ² |
| TERRAZA | 28.97 m ² |
| TOTAL SUPERFICIE ÚTIL | 119.29 m ² |

| SUPERFICIES CONST APROX. + PP. ZZCC. | |
|--------------------------------------|-----------------------|
| SUP. PLANTA PRINCIPAL + PP. DE ZZCC. | 134.75 m ² |
| SUP. TERRAZA | 32.36 m ² |
| TOTAL VIV. + TERRAZAS + ZZCC. | 167.71 m ² |



Las imágenes cartográficas contenidas en esta publicación son orientativas, no contractuales y están sujetas a modificación de proyecto. This is non-contractual document. The imperative determination of executive project can change.

DOSTĘPNOŚĆ NALEŻY ZWERYFIKOWAĆ U AGENTA

PONIENTE 6

Entrega en Septiembre de 2025

FASE III

| PLANTA | VIVIENDA | DORMITORIOS | Superf. Const. VIVIENDA m ² | TERRAZA m ² | JARDÍN | TOTAL m ² | PARKING | TRASTERO | PRECIO | |
|-----------------|----------|-------------|--|------------------------|--------|----------------------|---------|-----------|------------|--------|
| BAJA | A | 2 | 208,95 | 44,30 | 64,02 | 253,25 | 10 | 5 | 550.000 € | duplex |
| | B | 2 | 220,38 | 35,53 | 54,00 | 255,91 | 12 | 7 | 570.000 € | duplex |
| | C | 2 | 208,95 | 44,30 | 64,02 | 253,25 | 9 | 3 | 550.000 € | duplex |
| 1ª | A | 2 | 109,44 | 41,91 | 151,35 | 7 | 1 | 390.000 € | apartament | |
| | B | 2 | 98,60 | 49,50 | 148,10 | 14 | 10 | 380.000 € | apartament | |
| | C | 2 | 109,44 | 41,91 | 151,35 | 15 | 11 | 390.000 € | apartament | |
| 2ª | A | 2 | 109,44 | 41,91 | 151,35 | 22 | 12 | 400.000 € | apartament | |
| | B | 2 | 98,60 | 40,00 | 138,60 | 21 | 15 | 390.000 € | apartament | |
| | C | 2 | 109,44 | 41,91 | 151,35 | 31 | 22 | 400.000 € | apartament | |
| 3ª | A | 3 | 134,75 | 70,45 | 205,20 | 13 | 9 | reservado | | |
| | B | 2 | 109,99 | 56,27 | 166,26 | 8 | 2 | 430.000 € | apartament | |
| | C | 2 | 109,99 | 56,27 | 166,26 | 4 | 8 | reservado | | |
| 4ª | D | 3 | 134,75 | 70,45 | 205,20 | 11 | 6 | reservado | | |
| | A | 3 | 134,75 | 32,96 | 167,71 | 23 | 13 | reservado | | |
| | B | 2 | 109,99 | 23,44 | 133,43 | 6 | 4 | 420.000 € | apartament | |
| 5ª | C | 2 | 109,99 | 23,44 | 133,43 | 30 | 21 | 420.000 € | apartament | |
| | D | 3 | 134,75 | 32,96 | 167,71 | 29 | 20 | reservado | | |
| 5ª | A | 2 | 158,00 | 93,92 | 251,92 | 27 | 17 | reservado | | |
| | B | 2 | 150,47 | 79,64 | 230,11 | 24 | 14 | 590.000 € | duplex | |
| | C | 2 | 150,47 | 79,64 | 230,11 | 28 | 18 | 590.000 € | duplex | |
| TOTAL VIVIENDAS | D | 2 | 158,00 | 93,92 | 251,92 | 25,26 | 16 | reservado | | |
| | | | 21 | | | | | | | |

DOSTĘPNOŚĆ NALEŻY ZWERYFIKOWAĆ U AGENTA

PONIENTE 5

Entrega en Septiembre 2025

| PLANTA | VIVIENDA | DORMITORIOS | Superf. Const. VIVIENDA m ² | TERRAZA m ² | JARDIN | TOTAL m ² | PARKING | TRASTERO | PRECIO TARIFA (€) | |
|--------|----------|-------------|--|------------------------|--------|----------------------|---------|----------|-------------------|------------|
| BAJA | A 2 | 2 | 208,95 | 44,30 | 64,02 | 253,25 | 16 | 9 | 550.000 € | duplex |
| | B 2 | 2 | 220,38 | 35,53 | 54,00 | 255,91 | 14 | 6 | 570.000 € | duplex |
| | C 2 | 2 | 208,95 | 44,30 | 64,02 | 253,25 | 15 | 7 | 550.000 € | duplex |
| 1ª | A 2 | 2 | 109,44 | 41,91 | | 151,35 | 10 | 1 | reservado | |
| | B 2 | 2 | 98,60 | 49,50 | | 148,10 | 6 | 4 | 380.000 € | apartament |
| | C 2 | 2 | 109,44 | 41,91 | | 151,35 | 12 | 3 | 390.000 € | apartament |
| 2ª | A 2 | 2 | 109,44 | 41,91 | | 151,35 | 29 | 16 | 400.000 € | apartament |
| | B 2 | 2 | 98,60 | 40,00 | | 138,60 | 24 | 15 | reservado | |
| | C 2 | 2 | 109,44 | 41,91 | | 151,35 | 31 | 17 | 400.000 € | apartament |
| 3ª | A 3 | 3 | 134,75 | | 70,45 | 205,20 | 26 | 12 | reservado | |
| | B 2 | 2 | 109,99 | | 56,27 | 166,26 | 28 | 14 | 430.000 € | apartament |
| | C 2 | 2 | 109,99 | | 56,27 | 166,26 | 32 | 18 | 430.000 € | apartament |
| 4ª | A 3 | 3 | 134,75 | | 70,45 | 205,20 | 33; 21 | 20 | reservado | |
| | B 2 | 2 | 109,99 | 32,96 | | 167,71 | 13 | 5 | reservado | |
| | C 2 | 2 | 109,99 | 23,44 | | 133,43 | 5 | 8 | 420.000 € | apartament |
| 5ª | A 2 | 2 | 150,47 | 79,64 | | 230,11 | 11 | 2 | 590.000 € | duplex |
| | B 2 | 2 | 150,47 | 79,64 | | 230,11 | 35 | 22 | 590.000 € | duplex |
| | D 2 | 2 | 158,00 | 93,92 | | 251,92 | 34 | 21 | reservado | |

Entrega en Diciembre de 2024

PONIENTE 2

DOSTĘPNOŚĆ NALEŻY ZWERYFIKOWAĆ U AGENTA

FASE II

| PLANTA | VIVIENDA | DORMITORIOS | Superf. Const. VIVIENDA m ² | TERRAZA m ² | JARDIN | TOTAL m ² | PARKING | TRASTERO | PRECIO (€) | |
|-----------------|----------|-------------|--|------------------------|--------|----------------------|---------|----------|------------|------------|
| BAJA | A 2 | 2 | 112,25 | 38,26 | | 150,51 | 7 | 4 | 370.000 € | apartament |
| | B 2 | 2 | 226,15 | 35,53 | 54,00 | 261,68 | 11; 6 | 5 | reservado | |
| | C 2 | 2 | 212,29 | 44,30 | 64,02 | 256,59 | 12 | 6 | reservado | |
| 1ª | A 2 | 2 | 112,25 | 38,26 | | 150,51 | 5 | 8 | reservado | |
| | B 2 | 2 | 100,59 | 49,50 | | 150,09 | 8 | 1 | 380.000 € | |
| | C 2 | 2 | 111,66 | 41,91 | | 153,57 | 10 | 3 | reservado | |
| 2ª | A 2 | 2 | 112,25 | 38,26 | | 150,51 | 9 | 2 | reservado | |
| | B 2 | 2 | 100,59 | 40,00 | | 140,59 | 13 | 7 | reservado | |
| | C 2 | 2 | 111,66 | 41,91 | | 153,57 | 22 | 15 | reservado | |
| 3ª | A 3 | 3 | 137,47 | | 70,45 | 207,92 | 34 | 21 | reservado | |
| | B 2 | 2 | 112,22 | | 56,27 | 168,49 | 14 | 9 | reservado | |
| | C 2 | 2 | 112,22 | | 56,27 | 168,49 | 15 | 10 | reservado | |
| 4ª | A 3 | 3 | 137,47 | | 70,45 | 207,92 | 35; 17 | 22 | reservado | |
| | B 2 | 2 | 118,42 | 23,45 | | 141,87 | 16 | 11 | 420.000 € | apartament |
| | C 2 | 2 | 112,22 | 23,44 | | 135,66 | 32 | 18 | reservado | |
| 5ª | A 2 | 2 | 160,76 | 93,92 | | 254,68 | 26 | 12 | reservado | |
| | B 2 | 2 | 153,15 | 79,64 | | 232,79 | 28; 21 | 14 | reservado | |
| | C 2 | 2 | 153,15 | 79,64 | | 232,79 | 29,23 | 16 | reservado | |
| TOTAL VIVIENDAS | | | 21 | | | | | | | |

DOSTĘPNOŚĆ NALEŻY ZWERYFIKOWAĆ U AGENTA

PONIENTE 4

FASE III

| PLANTA | VIVIENDA | DORMITORIOS | Superf. Const. VIVIENDA m ² | TERRAZA m ² | JARDIN | TOTAL m ² | PARKING | TRASTERO | PRECIO | |
|-----------------|----------|-------------|--|------------------------|--------|----------------------|---------|----------|-----------|------------|
| BAJA | A 2 | 2 | 208,95 | 44,30 | 64,02 | 253,25 | 16 | 9 | 550.000 € | duplex |
| | B 2 | 2 | 220,38 | 35,53 | 54,00 | 255,91 | 14 | 6 | 570.000 € | duplex |
| | C 2 | 2 | 208,95 | 44,30 | 64,02 | 253,25 | 15 | 7 | 550.000 € | duplex |
| 1ª | A 2 | 2 | 109,44 | 41,91 | | 151,35 | 13 | 5 | reservado | |
| | B 2 | 2 | 98,60 | 49,50 | | 148,10 | 6 | 4 | reservado | |
| | C 2 | 2 | 109,44 | 41,91 | | 151,35 | 12 | 3 | 390.000 € | apartament |
| 2ª | A 2 | 2 | 109,44 | 41,91 | | 151,35 | 29 | 16 | reservado | |
| | B 2 | 2 | 98,60 | 40,00 | | 138,60 | 24 | 15 | reservado | |
| | C 2 | 2 | 109,44 | 41,91 | | 151,35 | 31 | 17 | 400.000 € | apartament |
| 3ª | A 3 | 3 | 134,75 | | 70,45 | 205,20 | 26 | 12 | reservado | |
| | B 2 | 2 | 109,99 | | 56,27 | 166,26 | 28 | 14 | reservado | |
| | C 2 | 2 | 109,99 | | 56,27 | 166,26 | 32 | 18 | 430.000 € | apartament |
| 4ª | A 3 | 3 | 134,75 | | 70,45 | 205,20 | 33 | 20 | reservado | |
| | B 2 | 2 | 109,99 | 32,96 | | 167,71 | 10 | 1 | reservado | |
| | C 2 | 2 | 109,99 | 23,44 | | 133,43 | 5 | 8 | 420.000 € | apartament |
| 5ª | A 2 | 2 | 158,00 | 93,92 | | 251,92 | 27; 25 | 13 | reservado | |
| | B 2 | 2 | 150,47 | 79,64 | | 230,11 | 11 | 2 | 590.000 € | duplex |
| | C 2 | 2 | 150,47 | 79,64 | | 230,11 | 35; 19 | 22 | reservado | |
| TOTAL VIVIENDAS | | | 21 | | | | | | | |

Entrega en Diciembre de 2024

PONIENTE 3

FASE II

| PLANTA | VIVIENDA | DORMITORIOS | Superf. Const. VIVIENDA m ² | TERRAZA m ² | JARDIN | TOTAL m ² | PARKING | TRASTERO | PRECIO (€) | |
|-----------------|----------|-------------|--|------------------------|--------|----------------------|---------|----------|------------|------------|
| BAJA | A 2 | 2 | 212,29 | 44,30 | 64,02 | 256,59 | 13 | 5 | 550.000 € | duplex |
| | B 2 | 2 | 226,15 | 35,53 | 54,00 | 261,68 | 12 | 3 | reservado | |
| | C 2 | 2 | 212,29 | 44,30 | 64,02 | 256,59 | 14 | 6 | 550.000 € | duplex |
| 1ª | A 2 | 2 | 111,66 | 41,91 | | 153,57 | 5 | 8 | reservado | |
| | B 2 | 2 | 100,59 | 49,50 | | 150,09 | 6 | 4 | reservado | |
| | C 2 | 2 | 111,66 | 41,91 | | 153,57 | 10 | 1 | reservado | |
| 2ª | A 2 | 2 | 111,66 | 41,91 | | 153,57 | 34 | 20 | reservado | |
| | B 2 | 2 | 100,59 | 40,00 | | 140,59 | 30 | 18 | reservado | |
| | C 2 | 2 | 111,66 | 41,91 | | 153,57 | 26 | 12 | reservado | |
| 3ª | A 3 | 3 | 137,47 | | 70,45 | 207,92 | 33,21 | 19 | reservado | |
| | B 2 | 2 | 112,22 | | 56,27 | 168,49 | 11 | 2 | reservado | |
| | C 2 | 2 | 112,22 | | 56,27 | 168,49 | 16 | 9 | reservado | |
| 4ª | A 3 | 3 | 137,47 | | 70,45 | 207,92 | 15 | 7 | reservado | |
| | B 2 | 2 | 118,42 | 23,45 | | 141,87 | 18 | 11 | reservado | |
| | C 2 | 2 | 112,22 | 23,44 | | 135,66 | 17 | 10 | 420.000 € | apartament |
| 5ª | A 2 | 2 | 160,76 | 93,92 | | 254,68 | 29,24 | 15 | reservado | |
| | B 2 | 2 | 153,15 | 79,64 | | 232,79 | 28; 25 | 14 | reservado | |
| | C 2 | 2 | 153,15 | 79,64 | | 232,79 | 27 | 13 | reservado | |
| TOTAL VIVIENDAS | | | 21 | | | | | | | |

DOSTĘPNOŚĆ NALEŻY ZWERYFIKOWAĆ U AGENTA

Kasia Wabia

Aria Home Invest S.L.U

☎ +48 601 56 88 44

☎ +34 674 427 308

✉ hello@ariaspain.com

🌐 www.ariaspain.com

ARIA
— SPAIN —Miembro de:
apiRAICV
4123