



## Calpe Beachfront Apartment

Offer ID: 16730

**From 680000 €**

\*Price does not include VAT



Completion date:



### Property Information

**Type:** Apartment

**Number of bathrooms:** 2

**Number of bedrooms:** 3

**Area:** 73.81 m<sup>2</sup>

**City:** Calpe



### Property Description











An exclusive property with direct access to the beach. Precious materials and an abundance of vegetation ensure perfect harmony between the houses and the natural environment in

which they are located. Flats and penthouses with large, bright spaces and spectacular terraces of more than 20 m2 in most of the properties, which offer magnificent views thanks to their glass balustrades.

Flats, penthouses with 1, 2, 3 and 4 bedrooms and magnificent terraces. Overlooking the sea on the hill in front of the "Isla del Fraile" with spectacular views. The flats have been designed to make the most of the natural light and spectacular views of the Mediterranean Sea from their large terraces.



## Advantages

-  First line beach
-  Air conditioning
-  Shared pool
-  Balcony/Terrace
-  Close to the sea
-  Parking
-  Elevator
-  Garden
-  Garage
-  Gated community



## What is included in the price

-  Furnished kitchen
-  Shared pool
-  Air conditioning
-  Furnished bathroom



## Gallery

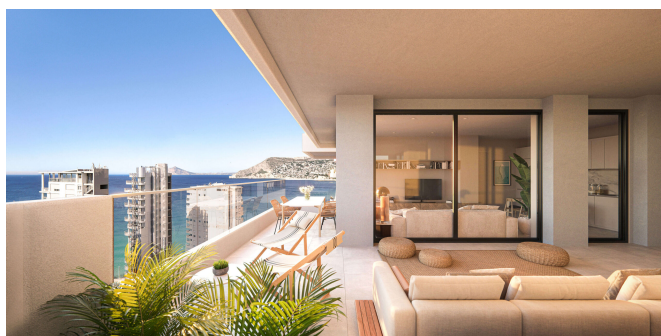



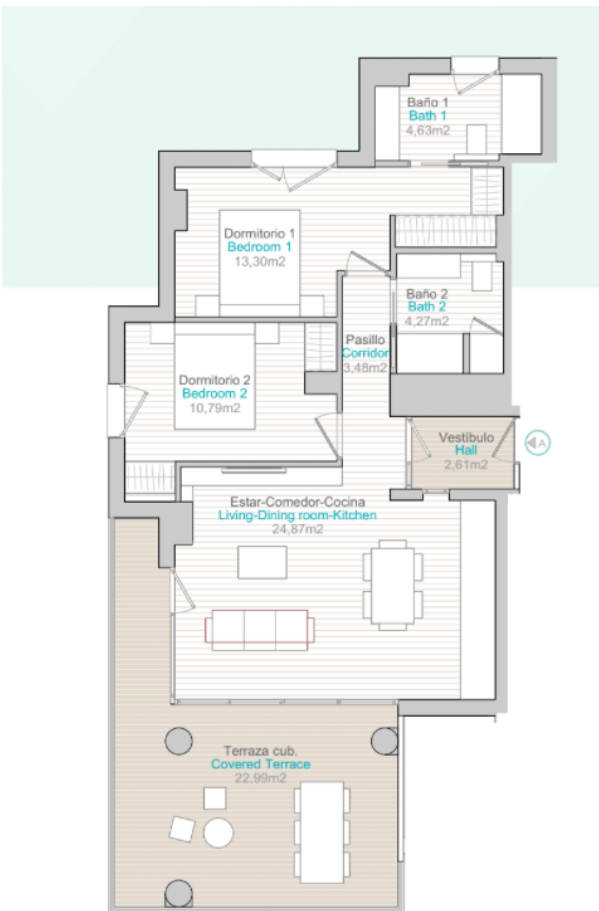
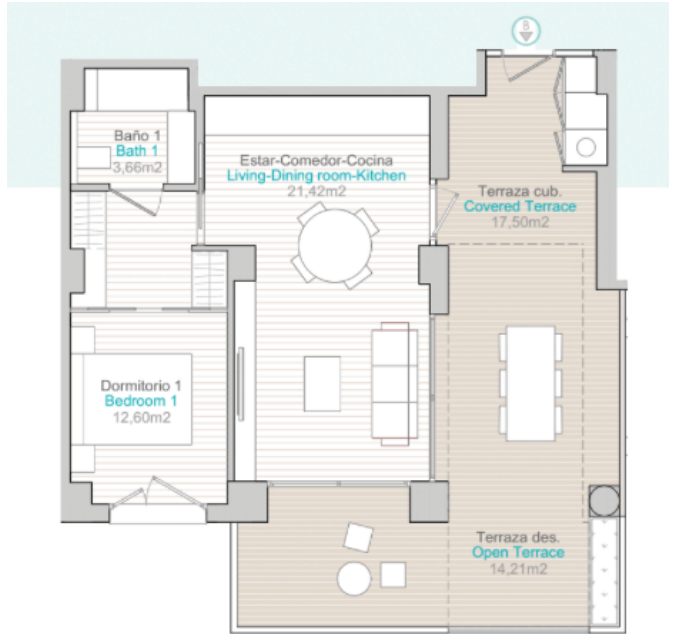
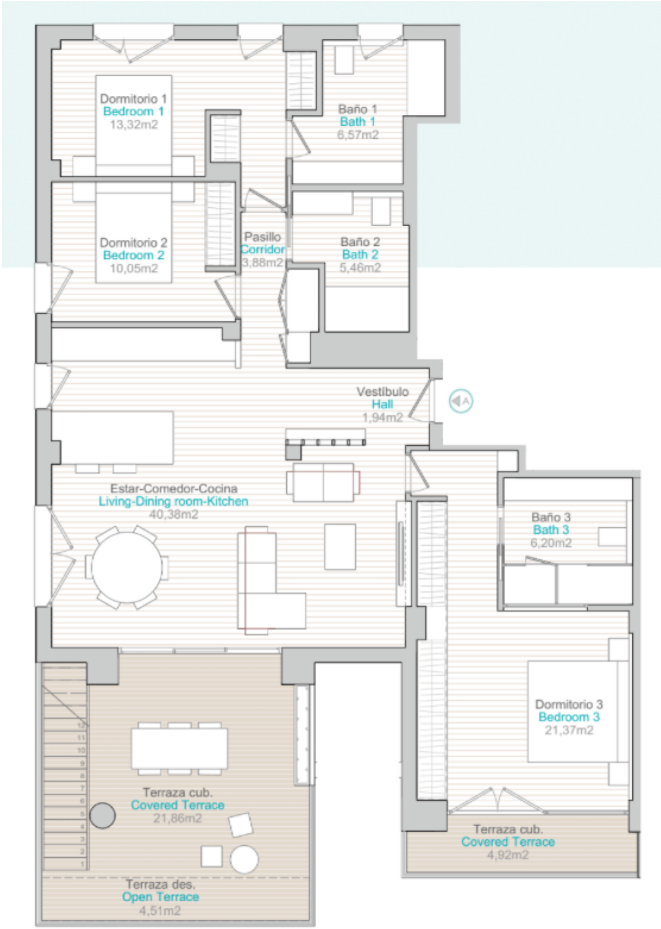

Tower	Floor	Door	Apartment	Bedrooms	Net sq. Apartments	Instr build sqm	Covered terrace	Open terrace	Solarium	Total terrace	Total build sqm	Orientation	TOTAL PRICE [VAT net inc.]	VAT	TOTAL PRICE [VAT inc.]	
1	1	A	1.0	2	62,48	77,07	28,87	6,87	0,00	35,74	132,44	OESTE	RESERVED			
1	1	B	1.0	1	22,66	46,11	16,85	15,80	0,00	32,65	85,28	OESTE	RESERVED			
1	1	C	1.0	2	44,77	61,06	20,94	10,89	0,00	31,83	132,89	ESTE	RESERVED			
1	2	A	2.0	4	63,82	79,50	32,36	17,92	0,00	50,28	190,80	OESTE	RESERVED			
1	2	B	2.0	1	36,83	45,30	14,43	5,79	0,00	20,22	85,72	OESTE	RESERVED			
1	2	C	2.0	2	46,95	61,26	20,85	8,98	0,00	29,83	110,26	ESTE	RESERVED			
1	3	A	3.0	2	41,33	75,37	28,83	6,50	0,00	35,33	107,70	OESTE	RESERVED			
1	3	B	3.0	1	36,83	44,61	16,85	12,57	0,00	29,42	76,34	CENTRAL	RESERVED			
1	3	C	3.0	2	42,7	76,49	30,19	2,53	0,00	32,72	109,21	ESTE	RESERVED			
1	4	A	4.0	2	42,44	77,07	32,16	2,53	0,00	34,69	111,76	OESTE	RESERVED			
1	4	B	4.0	1	36,83	45,32	15,11	8,79	0,00	23,90	86,27	CENTRAL	RESERVED			
1	4	C	4.0	2	42,79	76,49	29,46	6,80	0,00	36,26	112,65	ESTE	RESERVED			
1	5	A	5.0	2	42,44	77,07	24,52	10,53	0,00	35,05	111,64	OESTE	RESERVED			
1	5	B	5.0	1	36,83	44,59	19,99	12,83	0,00	32,82	76,41	CENTRAL	RESERVED			
1	5	C	5.0	2	46,52	61,26	22,80	8,86	0,00	31,66	112,11	ESTE	RESERVED			
1	6	A	6.0	2	42,7	76,49	27,39	10,80	0,00	38,19	113,88	OESTE	RESERVED			
1	6	B	6.0	1	36,83	45,30	16,79	5,79	0,00	22,58	86,48	CENTRAL	RESERVED			
1	6	C	6.0	2	42,83	76,50	16,79	27,67	0,00	44,47	124,17	ESTE	RESERVED			
1	7	A	7.0	2	42,44	77,07	28,84	9,40	0,00	38,24	114,69	OESTE	RESERVED			
1	7	B	7.0	1	36,83	44,59	16,79	12,57	0,00	29,36	76,34	CENTRAL	RESERVED			
1	7	C	7.0	2	42,54	75,37	27,32	0,80	0,00	27,52	102,69	ESTE	RESERVED			
1	8	A	8.0	1	36,83	45,30	16,79	5,79	0,00	22,58	86,48	CENTRAL	RESERVED			
1	8	B	8.0	2	42,44	77,07	28,79	2,01	0,00	30,79	107,88	OESTE	RESERVED			
1	8	C	8.0	3	73,84	89,48	24,67	8,23	0,00	32,90	122,40	ESTE	RESERVED			
1	9	A	9.0	2	42,82	76,50	16,79	27,67	0,00	44,46	115,29	OESTE	RESERVED			
1	9	B	9.0	1	36,83	44,59	16,79	12,57	0,00	29,36	76,34	CENTRAL	RESERVED			
1	9	C	9.0	2	42,44	77,07	28,79	1,77	0,00	30,56	108,05	OESTE	RESERVED			
1	9	D	9.0	3	73,84	89,22	22,77	12,36	0,00	35,13	122,76	ESTE	RESERVED			
1	10	A	10.0	1	41,24	75,37	27,32	0,80	0,00	27,52	102,19	OESTE	RESERVED			
1	10	B	10.0	2	36,83	44,59	24,23	7,27	0,00	31,50	76,34	CENTRAL	RESERVED			
1	10	C	10.0	2	42,44	77,07	24,62	16,40	0,00	41,04	117,41	ESTE	RESERVED			
1	12	A	12.0	2	42,23	76,49	30,46	4,47	0,00	34,93	111,42	OESTE	RESERVED			
1	12	B	12.0	1	36,83	44,59	19,79	12,83	0,00	32,62	76,41	CENTRAL	RESERVED			
1	12	C	12.0	3	73,83	89,22	27,80	12,54	0,00	40,34	124,76	ESTE	RESERVED			
1	12	D	12.0	4	62,44	77,07	26,83	12,62	0,00	39,45	119,44	OESTE	RESERVED			
1	12	E	12.0	1	36,83	45,30	14,43	5,79	0,00	20,22	85,72	CENTRAL	RESERVED			
1	12	F	12.0	2	42,44	77,07	26,83	12,62	0,00	39,45	119,44	OESTE	RESERVED			
1	14	A	14.0	2	73,83	89,23	27,80	12,54	0,00	40,34	124,64	OESTE	RESERVED			
1	14	B	14.0	1	36,83	44,59	16,79	12,57	0,00	29,36	76,41	CENTRAL	RESERVED			
1	14	C	14.0	2	42,83	76,50	16,79	27,67	0,00	44,47	124,17	ESTE	RESERVED			
1	15	A	15.0	1	36,83	44,59	16,79	12,57	0,00	29,36	76,41	CENTRAL	RESERVED			
1	15	B	15.0	2	42,44	77,07	28,79	2,01	0,00	30,79	107,88	OESTE	RESERVED			
1	15	C	15.0	3	73,83	89,23	27,80	12,54	0,00	40,34	124,64	OESTE	RESERVED			
1	15	D	15.0	4	62,44	77,07	26,83	12,62	0,00	39,45	119,44	OESTE	RESERVED			
1	15	E	15.0	1	36,83	45,30	14,43	5,79	0,00	20,22	85,72	CENTRAL	RESERVED			
1	15	F	15.0	2	42,44	77,07	26,83	12,62	0,00	39,45	119,44	OESTE	RESERVED			
1	17	A	17.0	3	76,11	91,35	19,26	8,19	0,00	27,45	118,40	OESTE	RESERVED	800.000	85.000	895.000
1	17	C	17.0	2	72,65	90,20	24,40	0,80	0,00	25,20	120,00	OESTE	RESERVED			

1	1	A	1.8	2	62.64	72.07	26.87	4.87	188.38	191.45	228.89	OKT9	RESERVADO			
2	1	B	1.8	1	27.68	46.71	18.85	0.30	0.00	34.15	80.28	CENTRAL	RESERVADO			
2	1	C	1.2	2	66.7	82.28	26.94	18.89	0.00	21.83	122.81	ETTE	RESERVADO			
2	2	A	2.4	2	43.82	29.50	12.38	0.79	0.00	41.16	124.46	OKT9	RESERVADO			
2	2	B	1.8	1	70.83	45.25	14.63	5.78	0.00	20.42	61.72	CENTRAL	RESERVADO			
2	2	C	2.2	2	44.19	81.25	25.02	4.88	0.00	29.89	173.74	ETTE	RESERVADO			
2	3	A	1.8	2	81.34	75.37	24.83	0.80	0.00	23.37	102.70	OKT9	RESERVADO			
2	3	B	1.8	1	36.83	44.41	16.38	12.57	0.00	31.95	76.36	CENTRAL	RESERVADO			
2	3	C	2.2	2	62.2	76.49	24.99	2.71	0.00	37.40	173.89	ETTE	RESERVADO			
2	4	A	1.8	2	42.44	72.07	22.16	1.73	0.00	37.37	114.38	OKT9	RESERVADO			
2	4	B	1.8	1	36.83	45.25	15.11	9.79	0.00	26.40	76.22	CENTRAL	RESERVADO			
2	4	C	2.2	2	42.19	76.49	29.66	4.00	0.00	36.16	122.64	ETTE	RESERVADO			
2	5	A	1.8	2	62.64	72.07	24.12	10.15	0.00	32.27	171.64	OKT9	RESERVADO			
2	5	B	1.8	1	36.83	44.28	19.99	12.02	0.00	22.43	78.41	CENTRAL	RESERVADO			
2	5	C	2.2	2	61.12	81.05	22.89	8.86	0.00	31.38	152.47	ETTE	RESERVADO			
2	6	A	1.8	2	62.2	76.49	27.39	5.52	0.00	22.72	109.27	OKT9	RESERVADO			
2	6	B	1.8	1	36.83	45.30	15.79	9.79	0.00	21.08	46.38	CENTRAL	RESERVADO			
2	6	C	2.2	2	43.81	79.50	16.79	12.62	0.00	44.47	161.71	ETTE	RESERVADO			
2	7	A	1.8	2	62.44	72.07	28.44	17.77	0.00	48.15	122.22	OKT9	RESERVADO			
2	7	B	1.8	1	36.83	44.28	16.38	12.57	0.00	21.54	76.34	CENTRAL	RESERVADO			
2	7	C	2.2	2	41.34	75.37	27.32	0.80	0.00	27.32	102.49	ETTE	RESERVADO			
2	8	A	1.8	2	62.44	72.07	26.75	0.80	0.00	26.75	105.47	OKT9	RESERVADO			
2	8	B	1.8	1	36.83	45.30	15.26	5.15	0.00	20.47	45.71	CENTRAL	RESERVADO			
2	8	C	2.2	2	72.64	89.48	24.47	8.28	0.00	15.82	122.40	ETTE	RESERVADO			
2	9	A	1.8	2	43.82	76.50	12.38	10.72	0.00	41.10	122.40	OKT9	RESERVADO			
2	9	B	1.8	1	37.58	46.71	21.95	2.77	0.00	21.90	80.07	CENTRAL	RESERVADO			
2	9	C	2.2	2	72.84	80.25	22.77	4.44	0.00	31.47	121.43	ETTE	RESERVADO			
2	10	A	1.8	2	62.44	72.07	26.75	0.80	0.00	26.75	105.47	OKT9	RESERVADO			
2	10	B	1.8	1	36.83	44.28	16.79	12.58	0.00	21.95	76.54	CENTRAL	RESERVADO			
2	10	C	2.2	2	42.44	72.07	29.16	16.48	0.00	48.52	126.99	ETTE	RESERVADO			
2	11	A	1.8	2	72.83	89.48	26.52	10.07	0.00	36.54	126.22	OKT9	RESERVADO			
2	11	B	1.8	1	36.83	45.31	14.63	5.79	0.00	20.42	45.72	CENTRAL	RESERVADO			
2	11	C	2.2	2	62.44	72.07	22.02	5.72	0.00	26.76	105.42	ETTE	RESERVADO			
2	12	A	1.8	2	62.22	76.49	30.46	4.47	0.00	34.99	111.47	OKT9	RESERVADO			
2	12	B	1.8	1	36.83	44.28	15.79	12.02	0.00	21.82	78.47	CENTRAL	RESERVADO			
2	12	C	2.2	2	72.81	80.25	21.89	12.74	0.00	33.94	124.74	ETTE	RESERVADO			
2	13	A	1.8	2	62.44	72.07	26.40	12.92	0.00	42.37	118.44	OKT9	RESERVADO			
2	13	B	1.8	1	36.83	45.30	14.63	5.79	0.00	20.42	45.72	CENTRAL	RESERVADO			
2	13	C	2.2	2	72.83	89.48	22.44	1.07	0.00	25.45	122.11	ETTE	RESERVADO	68.000	748.000	
2	14	A	1.8	2	72.83	80.22	21.89	8.47	0.00	31.47	121.44	OKT9	RESERVADO			
2	14	B	1.8	1	36.83	44.28	16.26	12.02	0.00	21.83	78.47	CENTRAL	RESERVADO			
2	14	C	2.2	2	43.81	79.50	15.89	27.42	0.00	43.81	123.27	ETTE	RESERVADO			
2	15	A	1.8	2	72.83	89.48	24.68	10.86	0.00	35.54	126.22	OKT9	RESERVADO			
2	15	B	1.8	1	36.88	44.67	14.63	5.79	0.00	20.42	45.89	CENTRAL	RESERVADO			
2	15	C	2.2	2	46.56	72.86	18.96	0.80	0.00	26.90	101.27	ETTE	RESERVADO			
2	16	A	1.8	2	72.83	80.21	22.06	9.38	0.00	31.40	121.43	OKT9	RESERVADO	725.000	72.500	874.500
2	16	B	1.8	1	36.83	44.68	24.99	2.48	0.00	24.99	76.38	CENTRAL	RESERVADO			
2	16	C	2.2	2	42.44	72.07	26.99	6.89	0.00	36.79	118.88	ETTE	RESERVADO			
2	17	A	1.8	2	76.11	81.26	19.06	4.17	0.00	27.22	118.28	OKT9	RESERVADO	810.000	23.000	833.000
2	17	B	1.8	1	37.66	45.70	27.16	4.60	0.00	33.06	70.36	CENTRAL	RESERVADO	410.000	47.000	517.000
2	17	C	2.2	2	17.81	40.22	31.40	4.12	18.20	38.32	120.74	ETTE	RESERVADO	810.000	81.000	891.000
2	18	A	1.8	2	120.17	120.17	120.17	0.00	188.28	191.45	120.17	OKT9	RESERVADO	1.810.000	610.000	2.420.000
2	18	B	1.8	1	36.83	45.30	14.63	5.79	0.00	20.42	45.72	CENTRAL	RESERVADO			

## Kasia Wabia

### Aria Home Invest S.L.U

+48 601 56 88 44

+34 674 427 308

hello@ariarealestate.eu

www.ariarealestate.eu

