



Calpe

Appartement en bord de mer

Numéro d'offre: 16742

À partir de 680000 €

*Le prix n'inclut pas la TVA



Date de livraison:



Informations sur la propriété

Type: Appartement

Nombre de salles de bain: 2

Nombre de chambres: 3

Surface: 73.81 m²

Ville: Calpe



Description de la propriété











Une propriété exclusive avec accès direct à la plage. Des matériaux précieux et une végétation abondante assurent une parfaite harmonie entre les maisons et l'environnement

naturel dans lequel elles se trouvent. Des appartements et des penthouses avec de grands espaces lumineux et des terrasses spectaculaires de plus de 20 m2 dans la plupart des propriétés, qui offrent des vues magnifiques grâce à leurs balustrades en verre.

Appartements et penthouses avec 1, 2, 3 et 4 chambres à coucher et de magnifiques terrasses. Surplombant la mer sur la colline en face de la « Isla del Fraile » avec des vues spectaculaires. Les appartements ont été conçus pour profiter au maximum de la lumière naturelle et des vues spectaculaires sur la mer Méditerranée depuis leurs grandes terrasses.



Atouts

- | | | |
|---|--|--|
|  Première ligne de plage |  Climatisation |  Piscine partagée |
|  Balcon/Terrasse |  Proche de la mer |  Parking |
|  Ascenseur |  Jardin |  Garage |
|  Résidence fermée | | |



Ce qui est inclus dans le prix

- | | |
|---|---|
|  Cuisine meublée |  Piscine partagée |
|  Climatisation |  Salle de bain meublée |



Galerie

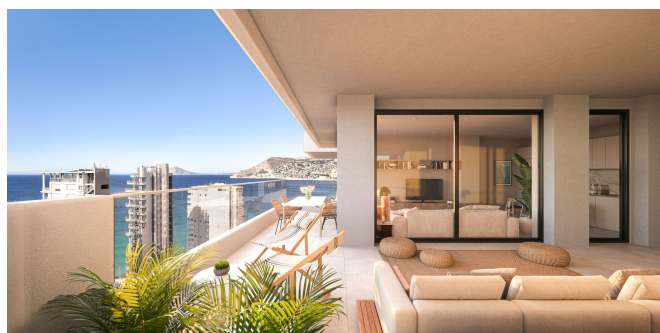



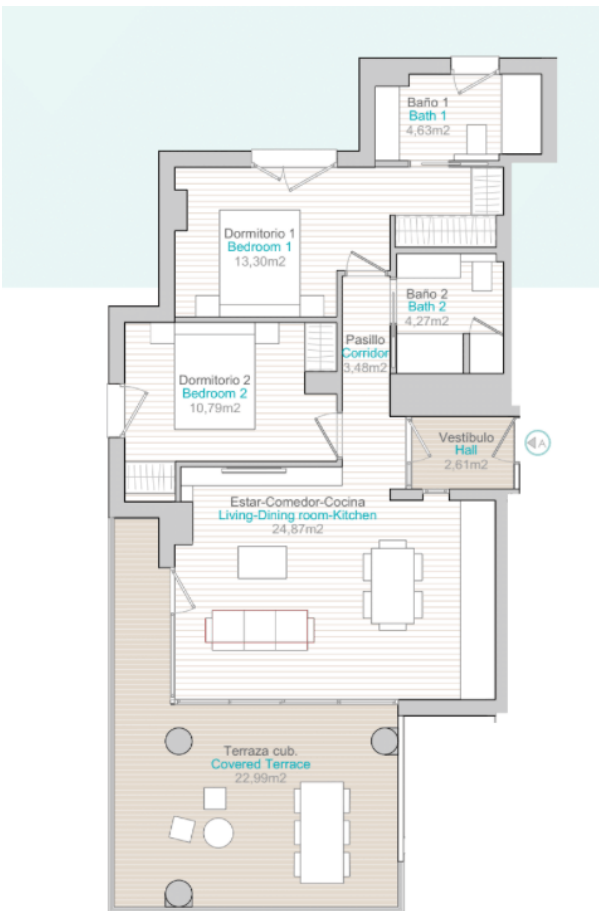
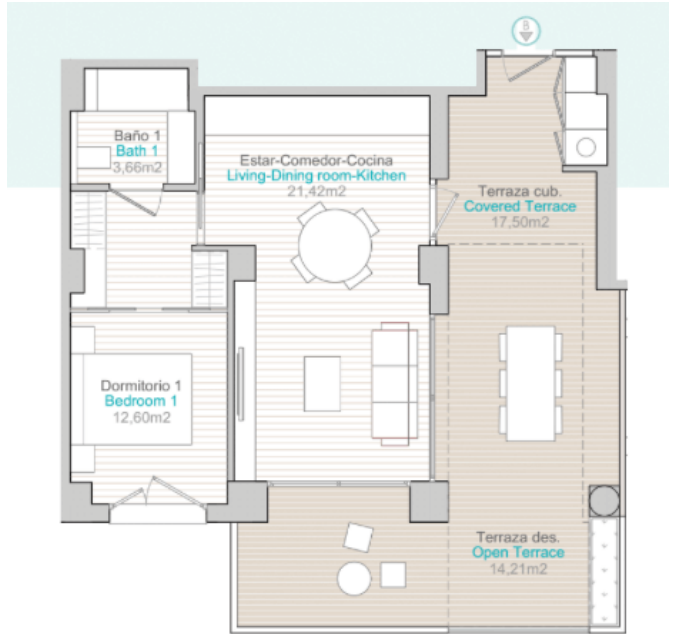
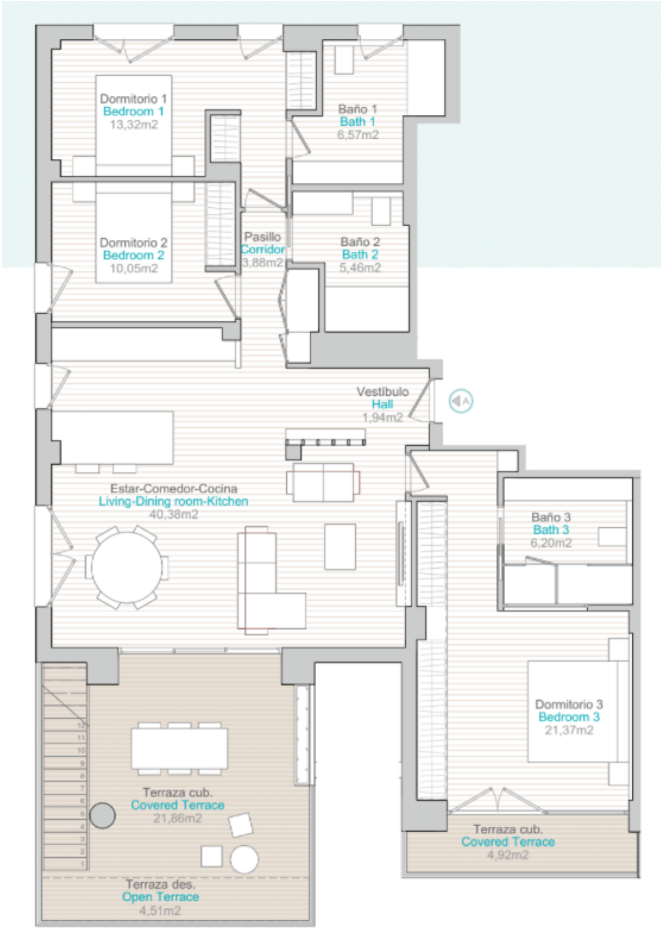

Tower	Floor	Door	Apartment	Bedrooms	Net sq. Apartments	Instr build sqm	Covered terrace	Open terrace	Solarium	Total terrace	Total build sqm	Orientation	TOTAL PRICE [VAT net inc.]	VAT	TOTAL PRICE [VAT inc.]	
1	1	A	1.0	2	62,48	77,07	28,87	6,87	0,00	35,74	132,44	OESTE	RESERVED			
1	1	B	1.0	1	22,66	46,11	16,85	15,20	0,00	32,05	88,28	OESTE	RESERVED			
1	1	C	1.0	2	44,77	61,06	20,94	10,89	0,00	31,83	112,89	ESTE	RESERVED			
1	2	A	2.0	2	43,82	78,50	12,36	17,92	0,00	30,28	110,80	OESTE	RESERVED			
1	2	B	2.0	1	36,83	45,30	14,43	5,79	0,00	20,22	66,52	OESTE	RESERVED			
1	2	C	2.0	2	46,95	61,26	20,03	8,98	0,00	29,01	110,26	ESTE	RESERVED			
1	3	A	3.0	2	41,33	75,37	20,83	6,50	0,00	27,33	102,70	OESTE	RESERVED			
1	3	B	3.0	1	36,83	44,61	16,50	5,27	0,00	21,76	78,36	CENTRAL	RESERVED			
1	3	C	3.0	2	42,7	76,49	20,79	2,53	0,00	23,32	108,21	ESTE	RESERVED			
1	4	A	4.0	2	42,44	77,07	22,19	2,53	0,00	24,72	111,76	OESTE	RESERVED			
1	4	B	4.0	1	36,83	45,32	15,11	5,79	0,00	20,90	86,27	CENTRAL	RESERVED			
1	4	C	4.0	2	42,79	76,49	20,46	6,80	0,00	27,26	112,65	ESTE	RESERVED			
1	5	A	5.0	2	42,44	77,07	24,52	10,23	0,00	34,75	111,84	OESTE	RESERVED			
1	5	B	5.0	1	36,83	44,39	19,99	12,83	0,00	32,82	76,41	OESTE	RESERVED			
1	5	C	5.0	2	46,32	61,26	20,80	8,98	0,00	29,78	112,41	ESTE	RESERVED			
1	6	A	6.0	2	42,7	76,49	22,79	10,20	0,00	32,99	113,68	OESTE	RESERVED			
1	6	B	6.0	1	36,83	45,30	15,79	5,79	0,00	21,58	86,48	OESTE	RESERVED			
1	6	C	6.0	2	42,83	76,50	18,79	27,67	0,00	46,47	124,17	ESTE	RESERVED			
1	7	A	7.0	2	42,44	77,07	26,84	9,40	0,00	36,24	114,49	OESTE	RESERVED			
1	7	B	7.0	1	36,83	44,39	18,79	12,87	0,00	31,66	76,54	OESTE	RESERVED			
1	7	C	7.0	2	42,54	75,37	23,22	0,20	0,00	23,42	102,69	ESTE	RESERVED			
1	8	A	8.0	2	42,44	77,07	26,79	2,03	0,00	28,82	112,10	OESTE	RESERVED			
1	8	B	8.0	1	36,83	45,30	15,26	5,78	0,00	21,04	85,71	CENTRAL	RESERVED			
1	8	C	8.0	2	42,83	76,50	18,79	27,67	0,00	46,46	124,11	OESTE	RESERVED			
1	9	A	9.0	2	42,83	76,50	18,79	27,67	0,00	46,46	124,11	OESTE	RESERVED			
1	9	B	9.0	1	36,83	44,39	18,79	12,87	0,00	31,66	76,54	OESTE	RESERVED			
1	9	C	9.0	2	42,83	76,50	18,79	27,67	0,00	46,46	124,11	OESTE	RESERVED			
1	10	A	10.0	2	42,83	76,50	18,79	27,67	0,00	46,46	124,11	OESTE	RESERVED			
1	10	B	10.0	1	36,83	44,39	18,79	12,87	0,00	31,66	76,54	OESTE	RESERVED			
1	10	C	10.0	2	42,83	76,50	18,79	27,67	0,00	46,46	124,11	OESTE	RESERVED			
1	11	A	11.0	2	42,23	76,49	20,46	4,47	0,00	24,93	111,42	OESTE	RESERVED			
1	11	B	11.0	1	36,83	44,39	19,79	12,83	0,00	32,62	76,41	OESTE	RESERVED			
1	12	A	12.0	2	42,23	76,49	20,46	4,47	0,00	24,93	111,42	OESTE	RESERVED			
1	12	B	12.0	1	36,83	44,39	19,79	12,83	0,00	32,62	76,41	OESTE	RESERVED			
1	12	C	12.0	2	42,23	76,49	20,46	4,47	0,00	24,93	111,42	OESTE	RESERVED			
1	13	A	13.0	2	42,44	77,07	26,84	12,42	0,00	39,26	119,44	OESTE	RESERVED			
1	13	B	13.0	1	36,83	45,30	14,43	5,79	0,00	20,22	66,52	OESTE	RESERVED			
1	13	C	13.0	2	42,44	77,07	26,84	12,42	0,00	39,26	119,44	OESTE	RESERVED			
1	14	A	14.0	2	42,83	76,50	18,79	27,67	0,00	46,46	124,11	OESTE	RESERVED			
1	14	B	14.0	1	36,83	44,39	18,79	12,87	0,00	31,66	76,54	OESTE	RESERVED			
1	14	C	14.0	2	42,83	76,50	18,79	27,67	0,00	46,46	124,11	OESTE	RESERVED			
1	15	A	15.0	2	42,83	76,50	18,79	27,67	0,00	46,46	124,11	OESTE	RESERVED			
1	15	B	15.0	1	36,83	44,39	18,79	12,87	0,00	31,66	76,54	OESTE	RESERVED			
1	15	C	15.0	2	42,83	76,50	18,79	27,67	0,00	46,46	124,11	OESTE	RESERVED			
1	16	A	16.0	2	42,83	76,50	18,79	27,67	0,00	46,46	124,11	OESTE	RESERVED			
1	16	B	16.0	1	36,83	44,39	18,79	12,87	0,00	31,66	76,54	OESTE	RESERVED			
1	16	C	16.0	2	42,83	76,50	18,79	27,67	0,00	46,46	124,11	OESTE	RESERVED			
1	17	A	17.0	3	76,91	111,35	39,26	8,19	0,00	47,45	183,63	OESTE	RESERVED	800.000	83.000	935.000
1	17	C	17.0	2	72,65	90,20	24,40	0,20	0,00	24,60	139,40	OESTE	RESERVED			

1	1	A	1.8	2	62.64	72.07	26.87	4.87	188.38	191.85	228.89	CEST	RESERVED			
2	1	B	1.8	1	27.68	46.71	18.85	0.30	0.00	34.15	80.28	CENTRAL	RESERVED			
3	1	C	1.2	2	66.7	81.28	26.94	18.89	0.00	21.83	121.81	EST	RESERVED			
4	2	A	2.4	2	43.82	29.50	12.38	0.79	0.00	41.16	124.46	CEST	RESERVED			
5	2	B	1.8	1	70.81	85.25	14.63	5.78	0.00	20.42	61.71	CENTRAL	RESERVED			
6	2	C	2.2	2	44.19	81.25	25.02	4.88	0.00	29.89	171.74	EST	RESERVED			
7	3	A	3.6	2	81.34	75.31	20.81	6.80	0.00	21.31	102.10	CEST	RESERVED			
8	3	B	2.8	1	36.83	44.41	16.38	12.57	0.00	31.95	76.36	CENTRAL	RESERVED			
9	3	C	2	2	62.2	76.49	20.99	2.71	0.00	37.40	171.89	EST	RESERVED			
10	4	A	4.8	2	42.44	72.07	22.16	1.73	0.00	37.37	114.38	CEST	RESERVED			
11	4	B	4.8	1	36.81	45.32	15.11	6.79	0.00	26.40	86.20	CENTRAL	RESERVED			
12	4	C	2	2	42.19	76.49	29.66	6.00	0.00	36.16	112.64	EST	RESERVED			
13	5	A	5.8	2	42.44	72.07	24.12	10.11	0.00	34.27	171.84	CEST	RESERVED			
14	5	B	5.8	1	36.81	44.28	19.99	12.02	0.00	20.40	76.41	CENTRAL	RESERVED			
15	5	C	2	2	46.12	81.05	22.89	8.86	0.00	31.38	152.47	EST	RESERVED			
16	6	A	6.8	2	42.2	76.49	27.39	5.52	0.00	22.72	109.27	CEST	RESERVED			
17	6	B	6.8	1	36.82	45.30	15.79	9.79	0.00	21.08	46.38	CENTRAL	RESERVED			
18	6	C	2	2	43.81	79.50	16.79	12.62	0.00	44.41	151.71	EST	RESERVED			
19	7	A	7.8	2	42.44	72.07	26.44	17.71	0.00	46.15	122.22	CEST	RESERVED			
20	7	B	7.8	1	36.82	44.28	16.38	12.62	0.00	21.34	76.34	CENTRAL	RESERVED			
21	7	C	2	2	41.34	75.37	27.32	0.00	0.00	27.32	102.49	EST	RESERVED			
22	8	A	8.8	2	42.44	72.07	26.75	6.00	0.00	26.75	105.47	CEST	RESERVED			
23	8	B	8.8	1	36.82	45.30	15.26	6.19	0.00	20.41	45.71	CENTRAL	RESERVED			
24	8	C	2	2	72.64	89.48	24.47	6.29	0.00	15.82	122.40	EST	RESERVED			
25	9	A	9.8	2	41.82	76.50	12.38	10.72	0.00	41.10	122.40	CEST	RESERVED			
26	9	B	9.8	1	37.58	46.21	21.91	2.77	0.00	21.90	80.07	CENTRAL	RESERVED			
27	9	C	2	2	72.84	80.22	22.77	4.44	0.00	31.41	171.43	EST	RESERVED			
28	10	A	10.8	2	41.44	72.07	29.06	16.48	0.00	44.52	126.99	CEST	RESERVED			
29	10	B	10.8	1	36.82	44.29	16.79	12.58	0.00	31.95	76.54	CENTRAL	RESERVED			
30	10	C	2	2	42.44	72.07	29.06	16.48	0.00	44.52	126.99	EST	RESERVED			
31	11	A	11.8	2	72.82	89.48	26.12	10.01	0.00	36.54	126.22	CEST	RESERVED			
32	11	B	11.8	1	36.82	45.31	14.63	5.79	0.00	20.42	45.72	CENTRAL	RESERVED			
33	11	C	2	2	42.44	72.07	22.02	5.72	0.00	26.76	105.42	EST	RESERVED			
34	12	A	12.8	2	42.22	76.49	30.46	4.47	0.00	34.99	111.42	CEST	RESERVED			
35	12	B	12.8	1	36.81	44.29	15.79	12.02	0.00	21.82	38.41	CENTRAL	RESERVED			
36	12	C	2	2	72.81	80.22	21.89	12.74	0.00	33.94	124.74	EST	RESERVED			
37	13	A	13.8	2	42.44	72.07	29.40	12.92	0.00	42.37	118.44	CEST	RESERVED			
38	13	B	13.8	1	36.81	45.30	14.63	5.79	0.00	20.40	45.72	CENTRAL	RESERVED			
39	13	C	2	2	72.81	89.48	22.44	1.01	0.00	25.45	121.11	EST	RESERVED	400.000	48.000	748.000
40	14	A	14.8	2	72.82	80.22	21.89	8.41	0.00	31.47	121.44	CEST	RESERVED			
41	14	B	14.8	1	36.81	44.28	16.26	12.02	0.00	21.81	38.41	CENTRAL	RESERVED			
42	14	C	2	2	43.81	79.50	15.89	27.42	0.00	43.81	123.27	EST	RESERVED			
43	15	A	15.8	2	72.82	89.48	24.68	10.86	0.00	35.54	126.20	CEST	RESERVED			
44	15	B	15.8	1	36.88	44.47	14.63	5.79	0.00	20.42	40.09	CENTRAL	RESERVED			
45	15	C	2	2	46.56	72.81	16.00	6.00	0.00	26.90	101.29	EST	RESERVED			
46	16	A	16.8	2	72.82	80.21	22.06	9.38	0.00	31.40	121.43	CEST	RESERVED	725.000	75.500	874.500
47	16	B	16.8	1	36.82	44.80	20.99	2.48	0.00	20.97	76.30	CENTRAL	RESERVED			
48	16	C	2	2	42.44	72.07	26.99	6.89	0.00	36.79	118.88	EST	RESERVED			
49	17	A	17.8	2	76.11	81.26	19.06	6.17	0.00	21.21	118.28	CEST	RESERVED	400.000	41.000	831.000
50	17	B	17.8	1	37.66	45.70	17.16	4.60	0.00	33.06	70.36	CENTRAL	RESERVED	400.000	41.000	511.000
51	17	C	2	2	178.81	80.22	31.40	4.12	16.20	38.32	120.74	EST	RESERVED	400.000	41.000	841.000
52	18	A	18.8	2	120.11	120.11	120.11	0.00	188.28	191.85	120.11	CEST	RESERVED	1.000.000	1.000.000	2.000.000
53	18	B	18.8	1	36.8	45.30	16.30	4.87	188.38	191.85	120.11	EST	RESERVED			

Kasia Wabia

Aria Home Invest S.L.U

+48 601 56 88 44

+34 674 427 308

hello@ariarealestate.eu

www.ariarealestate.eu

