



Calpe

## Lejlighed ved stranden

Tilbudsnummer: 4953

**Fra 470000 €**

\*Prisen inkluderer ikke moms



Afliveringsdato:



### Ejendomsinformation

**Type:** Lejlighed

**Antal badeværelser:** 1

**Antal soveværelser:** 1

**Areal:** 37.68 m<sup>2</sup>

**By:** Calpe







### Ejendomsbeskrivelse



En eksklusiv ejendom med direkte adgang til stranden. Ædle materialer og en overflod af vegetation sikrer perfekt harmoni mellem husene og det naturlige miljø, de ligger i. Lejligheder og penthouselejligheder med store, lyse rum og spektakulære terrasser på mere end 20 m<sup>2</sup> i de fleste af ejendommene, som byder på en storslået udsigt takket være deres glasbalustrader.

Lejligheder og penthouselejligheder med 1, 2, 3 og 4 soveværelser og storslåede terrasser. Med udsigt over havet på bakken foran "Isla del Fraile" med spektakulær udsigt. Lejlighederne er designet til at få mest muligt ud af det naturlige lys og den spektakulære udsigt over Middelhavet fra deres store terrasser.



## Fordele



-  Første linje strand
-  Altan/Terrasse
-  Elevator
-  Indhegnet område



-  Aircondition
-  Nær havet
-  Have

-  Fælles pool
-  Parkering
-  Garage



## Hvad er inkluderet i prisen

-  Møbleret køkken
-  Aircondition

-  Fælles pool
-  Møbleret badeværelse



## Galleri

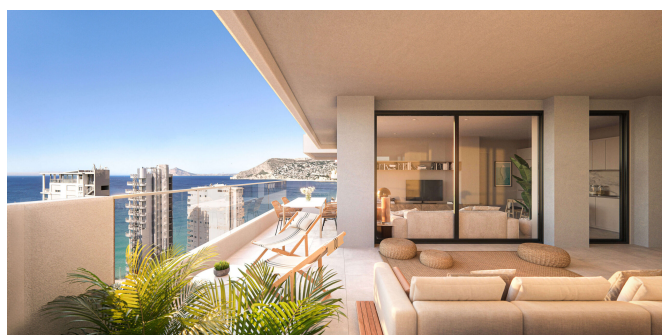





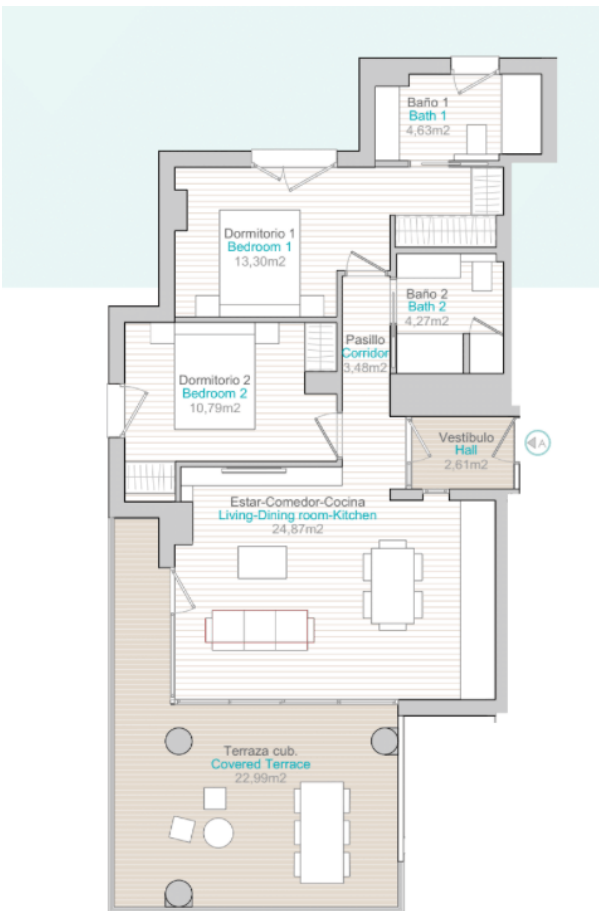
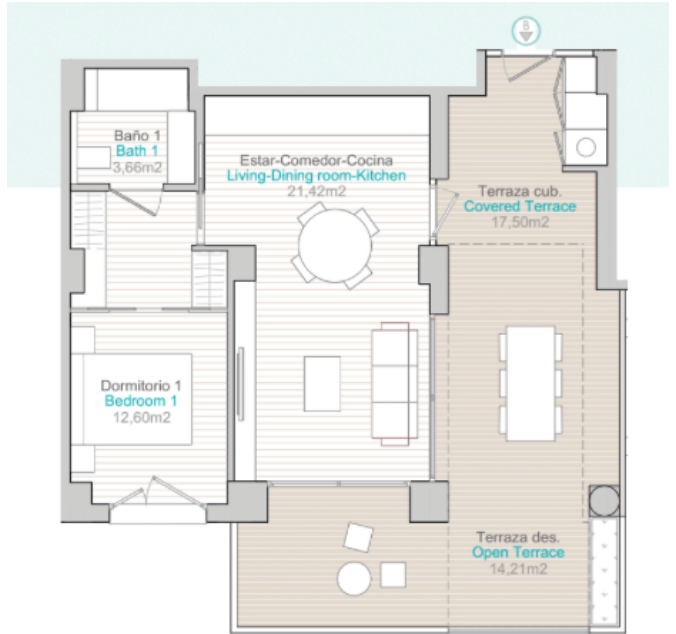
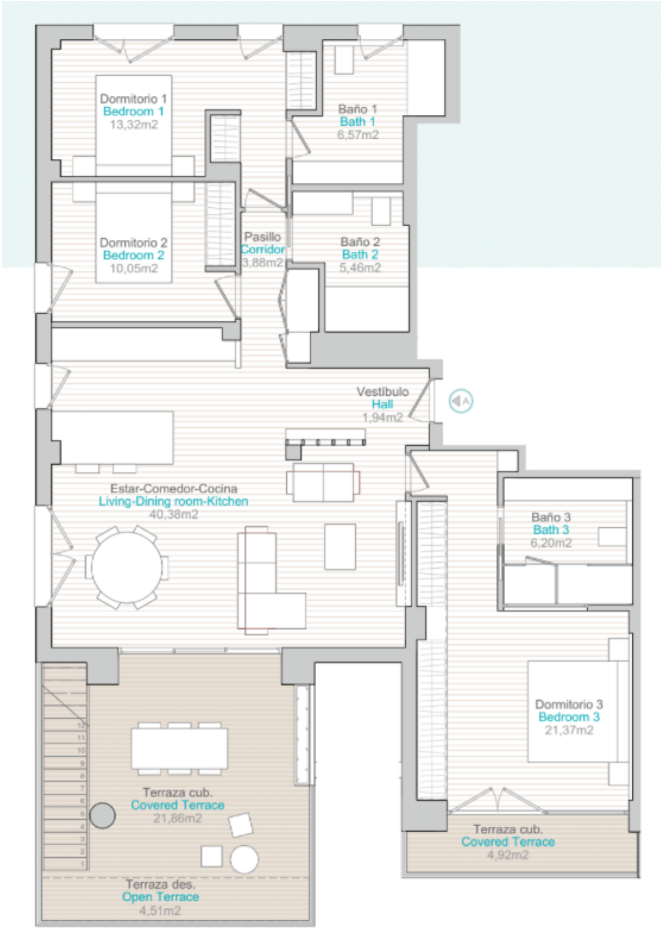

Tower	Floor	Door	Apartment	Bedrooms	Net sq. Apartments	Instr build sqm	Covered terrace	Open terrace	Solarium	Total terrace	Total build sqm	Orientation	TOTAL PRICE [VAT net inc.]	VAT	TOTAL PRICE [VAT inc.]	
1	1	A	1.0	2	62,48	77,07	28,87	6,87	0,00	35,74	132,44	OESTE	RESERVED			
1	1	B	1.0	1	22,66	46,11	16,85	15,80	0,00	32,65	85,28	OCCIDENTAL	RESERVED			
1	1	C	1.0	2	44,77	61,06	20,94	10,89	0,00	31,83	132,89	ESTE	RESERVED			
1	2	A	2.0	4	63,82	78,50	32,36	17,92	0,00	50,28	199,80	OESTE	RESERVED			
1	2	B	2.0	1	36,83	45,30	14,43	5,79	0,00	20,22	85,70	OCCIDENTAL	RESERVED			
1	2	C	2.0	2	46,95	61,26	20,85	8,98	0,00	29,83	110,28	ESTE	RESERVED			
1	3	A	3.0	2	41,33	75,37	28,83	6,50	0,00	35,33	107,70	OESTE	RESERVED			
1	3	B	3.0	1	36,83	44,61	16,85	12,57	0,00	29,42	76,34	OCCIDENTAL	RESERVED			
1	3	C	3.0	2	42,7	76,49	30,79	2,53	0,00	33,32	109,21	ESTE	RESERVED			
1	4	A	4.0	2	42,44	77,07	32,19	2,53	0,00	34,72	113,76	OESTE	RESERVED			
1	4	B	4.0	1	36,83	45,32	15,11	8,79	0,00	23,90	86,27	OCCIDENTAL	RESERVED			
1	4	C	4.0	2	42,79	76,49	29,46	6,80	0,00	36,26	112,65	ESTE	RESERVED			
1	5	A	5.0	2	42,44	77,07	24,52	10,23	0,00	34,75	111,84	OESTE	RESERVED			
1	5	B	5.0	1	36,83	44,39	19,99	12,83	0,00	32,82	76,41	OCCIDENTAL	RESERVED			
1	5	C	5.0	2	46,32	61,26	22,80	8,86	0,00	31,66	112,81	ESTE	RESERVED			
1	6	A	6.0	2	42,7	76,49	27,29	10,80	0,00	38,09	113,88	OESTE	RESERVED			
1	6	B	6.0	1	36,83	45,30	16,79	5,79	0,00	22,58	86,48	OCCIDENTAL	RESERVED			
1	6	C	6.0	2	42,83	76,50	16,79	27,67	0,00	44,47	124,11	ESTE	RESERVED			
1	7	A	7.0	2	42,44	77,07	28,84	9,40	0,00	38,24	114,69	OESTE	RESERVED			
1	7	B	7.0	1	36,83	44,39	16,79	12,57	0,00	29,36	76,34	OCCIDENTAL	RESERVED			
1	7	C	7.0	2	42,54	75,37	27,22	0,80	0,00	27,22	102,69	ESTE	RESERVED			
1	8	A	8.0	1	36,83	45,30	16,79	5,79	0,00	22,58	86,48	OCCIDENTAL	RESERVED			
1	8	B	8.0	2	42,44	77,07	28,79	2,03	0,00	30,79	107,85	OESTE	RESERVED			
1	8	C	8.0	1	36,83	45,30	16,79	5,79	0,00	22,58	86,48	OCCIDENTAL	RESERVED			
1	9	A	9.0	2	42,82	76,50	16,79	27,67	0,00	44,46	124,10	OESTE	RESERVED			
1	9	B	9.0	1	36,83	44,39	16,79	12,57	0,00	29,36	76,34	OCCIDENTAL	RESERVED			
1	9	C	9.0	2	42,82	76,50	16,79	27,67	0,00	44,46	124,10	OESTE	RESERVED			
1	10	A	10.0	2	42,82	76,50	16,79	27,67	0,00	44,46	124,10	OESTE	RESERVED			
1	10	B	10.0	1	36,83	44,39	16,79	12,57	0,00	29,36	76,34	OCCIDENTAL	RESERVED			
1	10	C	10.0	2	42,82	76,50	16,79	27,67	0,00	44,46	124,10	OESTE	RESERVED			
1	11	A	11.0	2	42,23	76,49	28,46	4,47	0,00	32,93	111,42	OESTE	RESERVED			
1	11	B	11.0	1	36,83	44,39	16,79	12,83	0,00	29,62	76,41	OCCIDENTAL	RESERVED			
1	12	A	12.0	2	42,23	76,49	28,46	4,47	0,00	32,93	111,42	OESTE	RESERVED			
1	12	B	12.0	1	36,83	44,39	16,79	12,83	0,00	29,62	76,41	OCCIDENTAL	RESERVED			
1	12	C	12.0	2	42,23	76,49	28,46	4,47	0,00	32,93	111,42	OESTE	RESERVED			
1	13	A	13.0	2	42,44	77,07	28,80	12,82	0,00	41,62	119,44	OESTE	RESERVED			
1	13	B	13.0	1	36,83	45,30	14,43	5,79	0,00	20,22	85,70	OCCIDENTAL	RESERVED			
1	13	C	13.0	2	42,44	77,07	28,80	12,82	0,00	41,62	119,44	OESTE	RESERVED			
1	14	A	14.0	2	42,82	76,50	16,79	27,67	0,00	44,46	124,10	OESTE	RESERVED			
1	14	B	14.0	1	36,83	44,39	16,79	12,57	0,00	29,36	76,34	OCCIDENTAL	RESERVED			
1	14	C	14.0	2	42,82	76,50	16,79	27,67	0,00	44,46	124,10	OESTE	RESERVED			
1	15	A	15.0	2	42,82	76,50	16,79	27,67	0,00	44,46	124,10	OESTE	RESERVED			
1	15	B	15.0	1	36,83	44,39	16,79	12,57	0,00	29,36	76,34	OCCIDENTAL	RESERVED			
1	15	C	15.0	2	42,82	76,50	16,79	27,67	0,00	44,46	124,10	OESTE	RESERVED			
1	16	A	16.0	2	42,82	76,50	16,79	27,67	0,00	44,46	124,10	OESTE	RESERVED			
1	16	B	16.0	1	36,83	44,39	16,79	12,57	0,00	29,36	76,34	OCCIDENTAL	RESERVED			
1	16	C	16.0	2	42,82	76,50	16,79	27,67	0,00	44,46	124,10	OESTE	RESERVED			
1	17	A	17.0	3	76,91	111,35	49,26	8,19	0,00	57,45	198,60	OESTE	RESERVED	800.000	85.000	885.000
1	17	C	17.0	2	72,65	90,20	24,60	0,80	0,00	25,40	120,00	OESTE	RESERVED			

1	1	A	1.8	2	62.64	72.07	26.87	6.50	0.00	20.87	124.64	CEXIP	RESERVADO			
2	1	B	1.8	1	27.68	46.71	18.85	0.30	0.00	34.15	80.28	CENTRAL	RESERVADO			
3	1	C	1.2	2	66.7	82.26	28.94	18.09	0.00	21.83	124.64	ETFE	RESERVADO			
4	2	A	2.4	2	43.82	29.50	12.38	0.79	0.00	41.16	124.64	CEXIP	RESERVADO			
5	2	B	1.8	1	70.81	45.25	14.63	5.78	0.00	20.42	61.71	CENTRAL	RESERVADO			
6	2	C	2.2	2	44.19	81.25	25.02	4.88	0.00	29.89	171.74	ETFE	RESERVADO			
7	3	A	1.8	2	81.54	75.31	24.83	6.98	0.00	17.37	102.70	CEXIP	RESERVADO			
8	3	B	1.8	1	36.87	44.41	16.38	12.57	0.00	31.95	76.36	CENTRAL	RESERVADO			
9	3	C	2.2	2	62.7	76.49	23.99	7.21	0.00	37.40	171.89	ETFE	RESERVADO			
10	4	A	1.8	2	42.44	77.07	22.16	1.73	0.00	37.37	114.38	CEXIP	RESERVADO			
11	4	B	1.8	1	36.81	45.32	15.77	6.28	0.00	28.40	76.20	CENTRAL	RESERVADO			
12	4	C	2.2	2	42.19	76.49	25.66	6.50	0.00	36.16	124.64	ETFE	RESERVADO			
13	5	A	1.8	2	42.44	77.07	24.12	11.11	0.00	34.27	171.84	CEXIP	RESERVADO			
14	5	B	1.8	1	36.81	44.28	19.99	12.02	0.00	22.82	76.41	CENTRAL	RESERVADO			
15	5	C	2.2	2	46.12	81.05	22.80	8.58	0.00	31.38	124.64	ETFE	RESERVADO			
16	6	A	1.8	2	62.7	76.49	27.39	5.12	0.00	22.72	104.27	CEXIP	RESERVADO			
17	6	B	1.8	1	36.82	45.30	15.79	5.79	0.00	27.08	46.38	CENTRAL	RESERVADO			
18	6	C	2.2	2	43.81	79.50	16.79	12.62	0.00	44.41	171.74	ETFE	RESERVADO			
19	7	A	1.8	2	42.44	77.07	28.44	17.77	0.00	48.15	122.22	CEXIP	RESERVADO			
20	7	B	1.8	1	36.82	44.28	16.38	12.62	0.00	21.95	76.34	CENTRAL	RESERVADO			
21	7	C	2.2	2	41.34	75.37	27.32	10.00	0.00	27.32	102.49	ETFE	RESERVADO			
22	8	A	1.8	2	42.44	77.07	26.75	6.00	0.00	26.75	105.42	CEXIP	RESERVADO			
23	8	B	1.8	1	36.82	45.30	15.26	5.15	0.00	20.41	45.71	CENTRAL	RESERVADO			
24	8	C	2.2	2	72.64	89.48	26.47	6.28	0.00	15.82	124.64	ETFE	RESERVADO			
25	9	A	1.8	2	43.82	76.50	12.38	10.72	0.00	41.10	122.80	CEXIP	RESERVADO			
26	9	B	1.8	1	37.58	46.31	20.99	5.77	0.00	21.90	60.07	CENTRAL	RESERVADO			
27	9	C	2.2	2	72.64	80.25	22.77	6.44	0.00	31.41	124.64	ETFE	RESERVADO			
28	10	A	1.8	2	42.44	77.07	25.06	16.48	0.00	48.52	126.99	CEXIP	RESERVADO			
29	10	B	1.8	1	36.82	44.28	16.79	12.58	0.00	21.95	76.54	CENTRAL	RESERVADO			
30	10	C	2.2	2	42.44	77.07	26.06	16.48	0.00	48.52	126.99	ETFE	RESERVADO			
31	11	A	1.8	2	72.63	89.48	26.12	10.01	0.00	36.54	124.64	CEXIP	RESERVADO			
32	11	B	1.8	1	36.82	45.31	14.63	5.79	0.00	20.42	45.72	CENTRAL	RESERVADO			
33	11	C	2.2	2	42.44	77.07	22.02	5.72	0.00	26.76	105.42	ETFE	RESERVADO			
34	12	A	1.8	2	42.22	76.49	30.46	4.47	0.00	34.99	111.42	CEXIP	RESERVADO			
35	12	B	1.8	1	36.81	44.28	15.79	12.02	0.00	21.82	76.41	CENTRAL	RESERVADO			
36	12	C	2.2	2	72.61	80.22	21.80	12.74	0.00	33.94	124.64	ETFE	RESERVADO			
37	13	A	1.8	2	42.44	77.07	26.40	12.62	0.00	42.37	118.44	CEXIP	RESERVADO			
38	13	B	1.8	1	36.81	45.30	14.61	5.79	0.00	20.40	45.71	CENTRAL	RESERVADO			
39	13	C	2.2	2	72.61	89.48	21.44	11.01	0.00	32.45	124.64	ETFE	RESERVADO	60.000	748.000	
40	14	A	1.8	2	72.63	80.22	21.80	8.41	0.00	31.47	124.64	CEXIP	RESERVADO			
41	14	B	1.8	1	36.81	44.28	16.26	12.62	0.00	21.83	76.41	CENTRAL	RESERVADO			
42	14	C	2.2	2	43.81	76.50	15.89	27.62	0.00	43.81	124.64	ETFE	RESERVADO			
43	15	A	1.8	2	72.63	89.48	24.68	10.06	0.00	35.54	126.20	CEXIP	RESERVADO			
44	15	B	1.8	1	36.88	44.67	14.63	5.79	0.00	20.42	45.09	CENTRAL	RESERVADO			
45	15	C	2.2	2	46.36	77.36	18.06	6.00	0.00	26.90	105.42	ETFE	RESERVADO			
46	16	A	1.8	2	72.63	80.21	22.06	9.38	0.00	31.40	124.64	CEXIP	RESERVADO	725.000	72.500	874.500
47	16	B	1.8	1	36.87	44.68	24.99	2.48	0.00	24.99	76.49	CENTRAL	RESERVADO			
48	16	C	2.2	2	42.44	77.07	26.99	6.80	0.00	36.79	118.48	ETFE	RESERVADO			
49	17	A	1.8	2	76.11	81.26	19.06	6.17	0.00	21.21	118.28	CEXIP	RESERVADO	21.000	810.000	
50	17	B	1.8	1	17.66	45.70	17.16	4.60	0.00	10.06	70.06	CENTRAL	RESERVADO	40.000	47.000	517.000
51	17	C	2.2	2	17.61	40.22	11.40	4.12	0.00	16.32	120.74	ETFE	RESERVADO	80.000	81.000	816.000
52	18	A	1.8	2	120.11	120.11	120.11	0.00	0.00	120.11	120.11	CEXIP	RESERVADO	1.500.000	600.000	1.500.000
53	18	B	1.8	1	120.11	120.11	120.11	0.00	0.00	120.11	120.11	CEXIP	RESERVADO			

# Kasia Wabia

Aria Home Invest S.L.U

+48 601 56 88 44

+34 674 427 308

hello@ariaspain.com

www.ariaspain.com

